

# **AIR HOSE REEL RETRACTABLE OPERATION MANUAL**



**PLEASE READ THE MANUAL CAREFULLY BEFORE OPERATING OR  
SERVICING THE TOOL.**

## Introduction

---

With an extra long 30m hose that offers you unbridled movement around the work area from one connection point, this retractable air hose reel is made from durable PVC with premium stainless steel 1/4 NPT quick connect fittings. Linking the hose to a compressor is easy via the 2m leader hose that connects to the side of the unit. The spring-loaded hose utilizes an incremental feed lock that allows the extended hose to the desired hoe length for the job. After the work is done, just give the hose a firm tug to activate the rewind function. As the hose winds back into the housing, its self-layering mechanism will ensure the winding is done neatly and evenly within the housing.

The air hose reel can be swivelled to 180° when mounted on the wall which allows the hose to easily travel around corners. If required, the unit can be dismounted from the wall via sliding out the connecting hinge rod. Once out, the unit can be reallocated to another location.

Other handy features include a rear leader hose holster that provides a safe and tidy connection between the compressor and the reel, an internal access hatch located at the top of the housing a top-mounted swive carry handle.

## Safety Guidelines

---

To prevent injury or damage, do not release the hose during the rewinding operation.

- Do not disassemble the hose reel.
- Ensure the reel or hose is not in contact with any sharp objects or exposed to temperature exceeding the recommended.
- Do not drop this reel as it will damage the housing and possibly the inner components.

## Installation

---

1. Ensure the location for the unit to be mounted is in a safe and secure location
2. Ensure there is enough room for the bracket (> 80 cm) and the unit can swivel 180°.
3. Drill holes at the same pitch to the wall bracket provided. 4 drilled holes at 60mm, the other 2 holes for the plastic bracket should be 40mm.
4. Securely fit the wall bracket to the wall, then secure the unit to the bracket.

## REEL MOUNTING DIAGRAM

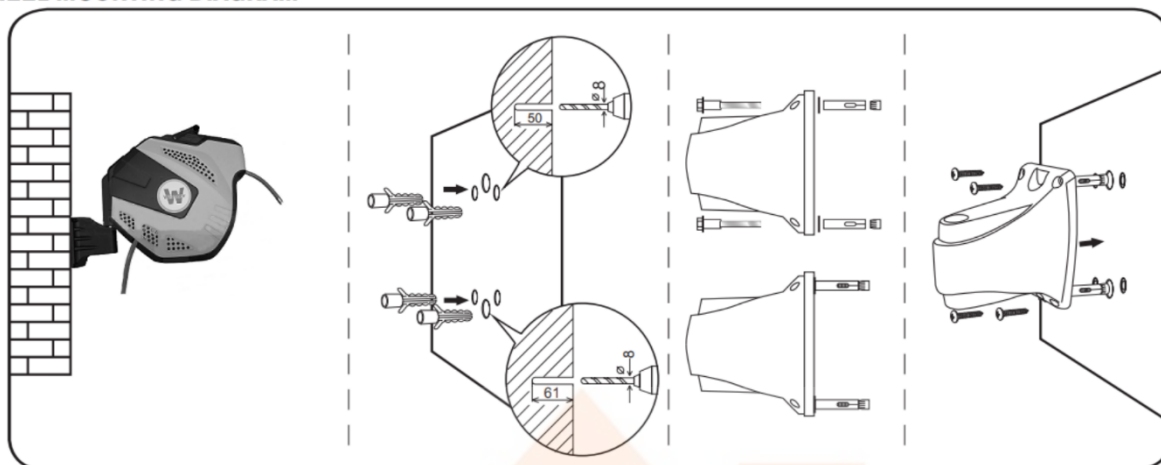

## Operation

1. To operate, pull the hoses out to the desired length and allow the hose to latch.
2. When finished, pull the hose to release the latch and allow the hose to recoil into the reel.

## Specifications

<b>Hose Length</b>	30m PVC Air Hose
<b>Leader Hose</b>	2m PVC Air Hose
<b>Hose Material</b>	UV resistant PVC
<b>Fitting</b>	1/4" BSPT
<b>Hose I.D.</b>	3/8"
<b>Working Pressure</b>	8 Bar / 116 PSI
<b>Burst Pressure</b>	24 Bar / 384 PSI
<b>Reel Housing Material</b>	Polypropylene
<b>Working Temperature</b>	-5°C ~ +45°C

## Maintenance

---

- After use, ensure air pressure is released before starting the rewind process.
- Do not leave the hose reel exposed to temperatures exceed the minimum and maximum recommended working temperature. Temperatures exceeding the maximum can damage the hose causing it to split. For temperature lower than the minimum working temperatures, it can cause the hose to lose its flexibility making it difficult to rewind.
- Wipe down the hose and housing periodically with a soft towel. Use of a mild detergent such as soap to clean the reel can be used if required.
- Do not use any chemicals or substances such as acetone, white spirits, lactic acid etc.
- Do not submerge the reel into water to clean it.
- Mount the reel in a sheltered and shaded location in order to prolong the life expectancy and to ensure maximum period of trouble-free service.
- Check weekly that the reel and the hose is in working condition.
- When not in use for an extended period, it is best to store the unit in a garage or shed.

## Troubleshooting

---

The most common malfunction is that the hose does not retract automatically after full extending the hose. The reason can be that the hose end is locked because of the 'stop-anywhere' mechanism is in the locking point and there is no extra hose to be pulled out to release. There are two solutions:

1. Hold the hose at the yellow warning mark and pull with a jerking motion until the hose retracts.
2. Place the reel down on its right side, then pull on the hose until it retracts.

*Address: 5 Lyn Parade, PRESTONS, NSW 2170*

*E-mail: [sales@mtmwarehouses.com.au](mailto:sales@mtmwarehouses.com.au)*

*Telephone: (02) 9607 4300*