

Flexible Synthetic Tyre Coupling

Flexible Synthetic Tyre Coupling Taper Lock Flange Mount



Flexible Synthetic Tyre Coupling

The Tyre coupling has two half flanges joined by a high-quality flexible rubber Tyre. The Tyre itself is torsionally soft and elastic, Having incredible vibration, shock loading and backlash absorbing qualities. The High-Grade Synthetic Rubber Tyre coupling allows up to 4° angular, 6 mm parallel and 8 mm axial misalignment. The high performing Tyre coupling is lubrication free with a simple time saving installation process. The Tyre Coupling are available with the taper lock bush which can be easily adapted to your machine. We can also supply with FRAS Fire Resistant tyre for additional cost.

**Please select a Coupling Size
from the Drop-down box.**

Mounting Type:

- Taper lock Flange

Features:

- High Grade Cast Iron construction
- Does not need any lubrication and can work in environments contaminated with oil, dirt, sand, moisture and grease
- Synthetic Rubber Tyre absorb shock loading, vibration, impulse, expansion and also allow for common misalignment.
- Ease of maintenance - Synthetic Rubber Rings can be easily removed and changed

Dimensions:

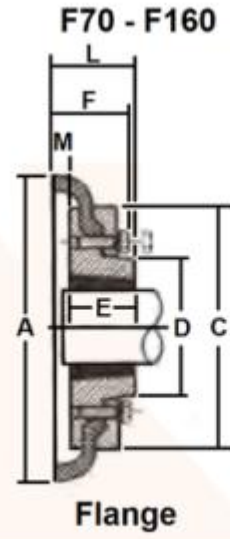
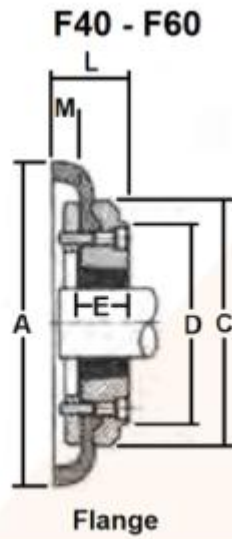

Size	A	C	D	E	F	L	M	Weight (Kg)
F40	104	82	-	22	-	33.5	11	0.8
F50	133	100	79	25	-	38	12.5	1.2
F60	165	125	103	25	-	42	16.5	2
F70	187	144	80	32	50	44	11.5	3.1
F80	211	167	98	45	54	58	12.5	4.9
F90	235	188	108	45	60	59	13.5	7
F100	254	216	120	51	62	65	13.5	9.9
F110	279	233	134	51	62	63.5	12.5	11.7
F120	314	264	140	65	67	78.5	14.5	16.5
F140	359	311	178	65	73	81	16	22.3
F160	402	345	197	77	78	92	15	32.5

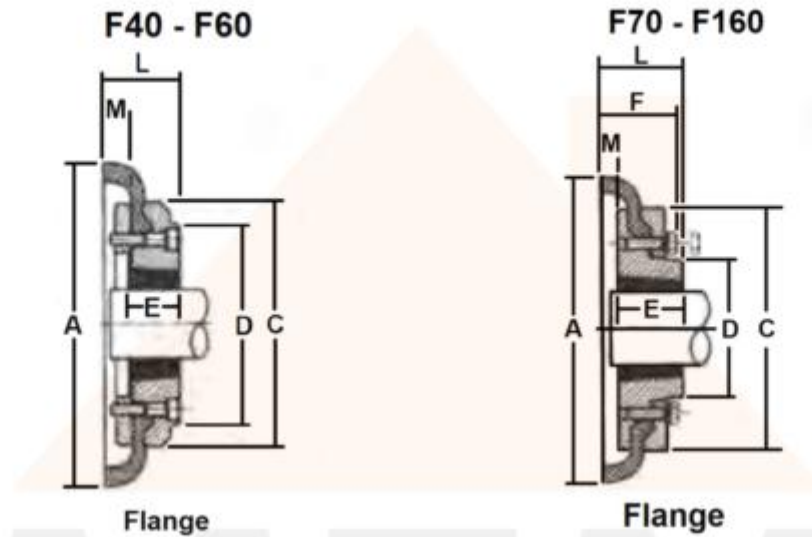

Size	Power @ 100 rpm (W)	Nominal Torque (N.m)	Max Speed (RPM)	Bore		Flange	Max Misalignment		End Float
				Max	Min		Parallel	Angular	
F40	260	25	4500	25	10	1008	1.1	4	1.3
F50	690	66	4500	32	11	1210	1.3	4	1.7
F60	1330	127	4000	42	14	1610	1.6	4	2
F70	2620	250	3600	50	14	2012	1.9	4	2.3
F80	3930	375	3100	65	14	2517	2.1	4	2.6
F90	5240	500	3000	65	16	2517	2.4	4	3
F100	7070	675	2600	75	16	3020	2.6	4	3.3
F110	9200	875	2300	75	24	3020	2.9	4	3.7
F120	13900	1300	2050	100	24	3525	3.2	4	4
F140	24300	2320	1800	100	35	23525	3.7	4	4.6
F160	39400	3770	1600	115	40	4030	4.2	4	5.3

Includes:

- 1 x Flexible Tyre Coupling (sizes from F40 - F160)

We do not deliver to PO Boxes. Please make sure you have a residential address in your details for us to send your order to.

Local Pick up from our Sydney, Prestons Warehouse available.

You are buying from a professional Business with many years experience in this market. DO NOT compare this product with other cheaper prices or even

same prices. This is commercial quality. Limited Time Offer. QUALITY at the right PRICE. This crazy price will not last long.

Payment Methods Accepted



Listing Details

When making a purchase from any of our eBay listings you are entering into a contract governed by our terms & conditions below. Please ensure you have read these before making your purchase.

Images shown are for demonstration purposes only. Product will match description but may vary from images shown. For any concerns about how a product looks please contact us before ordering.

The item description/price/stock levels is accurate to our knowledge. All errors or omissions are unintentional. If problems are encountered, please contact us.

Payment

Full payment is required within 5 days of sale. Payment can be made by Cash on pick-up (from our Warehouse), Paypal, credit card (over the phone) or bank deposit. Items will not be shipped out unless payment has been made in full.

Shipping/Delivery/Pick up

Please refer to our shipping tab at the top of our listing for all freight costs and delivery times. Your order will be sent through one of our delivery partners which include Toll, TNT, Couriers Please, E-Go, Go Logistics and Australia Post. The service used to deliver your order will be automatically selected by our freighting system. We assume no liability for postal delays or lost/damaged parcels, but we will assist the buyer to locate or to obtain a replacement.

We require a valid street address for all deliveries. We do NOT deliver to PO Boxes, Parcel Lockers or Post Office addresses. We also require a daytime phone number for all orders. Our operation hours for dispatch are Monday to Friday 9am to 2:30pm. In the

unlikely case that you do not receive your order, please contact us to resolve this.

Local Pickup from our Sydney, Prestons Warehouse available.

Warranty

Warranty periods are as follows:

- All remotes and receivers have 3 months warranty
- Garage door and gate motors have 12 months warranty
- All other products have 6 months warranty

If you have a problem with the product, please contact us through eBay and include the original purchase information (i.e. your name, address, email and purchase receipt number)

Warranty does not include damage caused by normal wear and tear, accidents, misuse, lack of maintenance, neglect, natural disaster, or other external causes; to damage caused by operating the equipment in a manner outside that described in the instructions. The warranty is considered void if the item has been modified, altered or tampered with by a person(s) not authorised by us to provide service (with the exception of standard periodic maintenance). Consumables and accessories such as chains, carry bags, batteries, hoses, grinding discs, belts, cables, wheels, blades, tubs, pads, nets etc. are also not covered once used or for damage caused by general wear and tear.

Until the nature of any fault is determined, the resolution we can offer may vary. To assist with a quick resolution, photos of the damaged part/unit will be required for verification. We will repair or replace, at our discretion, any unit determined to be within the warranty period. Where necessary, the item may need to be returned to repair the fault/issue.

The buyer will be liable for all shipping costs associated with any warranty claim.

All returns for warranty must first be authorised in writing by our Customer Service Team and given a Return Authorisation Number (RAN). We will not accept the return of any item/s without a Return Authorisation Number (RAN).

When a return is authorised, it is the buyer's responsibility to ensure the product is packaged securely to prevent any damage during the return process. Failure to do so may affect the resolution to be offered, which may include repairs, replacement items or store credit at our discretion.

For all warranty claims, the outcome of the inspection should take no longer than 10 business days from the date the item is received by our service department (times may vary).

Warranty claims will not be accepted in cases where the buyer has contributed to the failure, or been misleading in their description of their issues. In these instances, where freight costs

were incurred by us to return your item for inspection, reimbursement to us may be required prior to releasing the goods. The item is also to be returned to the buyer at the buyer's expense. Freight cost not to exceed original freight cost. Payment is to be made to us within 7 days of being notified of warranty rejection. Storage fees to apply beyond 7 days at 5% per week of the original product cost until the credit expires. Where money is owed to us for repairs and/or postage, we will be entitled to hold onto the item until payment is made.

Returns/Exchanges

Returns or exchanges must be made within 7 days of the delivery date. After 7 days, any claims of delivery errors or requests for returns or exchanges will not be accepted.

Products may be returned/exchanged provided that the item(s) are returned in an unused, clean, sellable condition with original packaging, subject to our discretion.

If the item has sustained damage in transit, or is not returned as noted above, a revised refund amount may be required.

All returns will be refunded less the delivery cost. All exchanges will incur a return delivery fee.

We reserve the right as final authority on whether the products should be refunded or replaced and make no other warranty and no implied warranties, including any warranty of merchantability or fitness for a particular purpose. Our maximum liability hereunder is limited to the purchase price of the products. In no event shall we be liable for any consequential, indirect, incidental or special damages of any nature arising from the sale of the product.

If you accept these terms and wish to return an item, please send us a message stating your name, order number, the item(s) you wish to return, and the reason for the return. Our Customer Service team will respond to your email and, if applicable, written authorisation for the return will be given. All other relevant information will also be given to you at this time. We will not accept the return of any item(s) without our prior authorisation.

Contact Us

If you have any questions or enquiries, please send us a message through eBay.

Feedback

At MTM we strive to maintain an excellent customer service so if you have any issues or inquiries about your purchase, please feel free to contact us before leaving feedback and we would be happy to help. Please do not leave negative feedback before contacting us.

Any negative feedback left without any contact will be regarded as an indication of the

conclusion of the transaction.

By placing a bid or buying, you have agreed to all the conditions mentioned above.